

175 WEST JACKSON CHICAGO IL

14. All signage complies with ICC / ANSI A117.1-2009 Chapter 703. See ICC / ANSI A117.1-2009 703.3.11

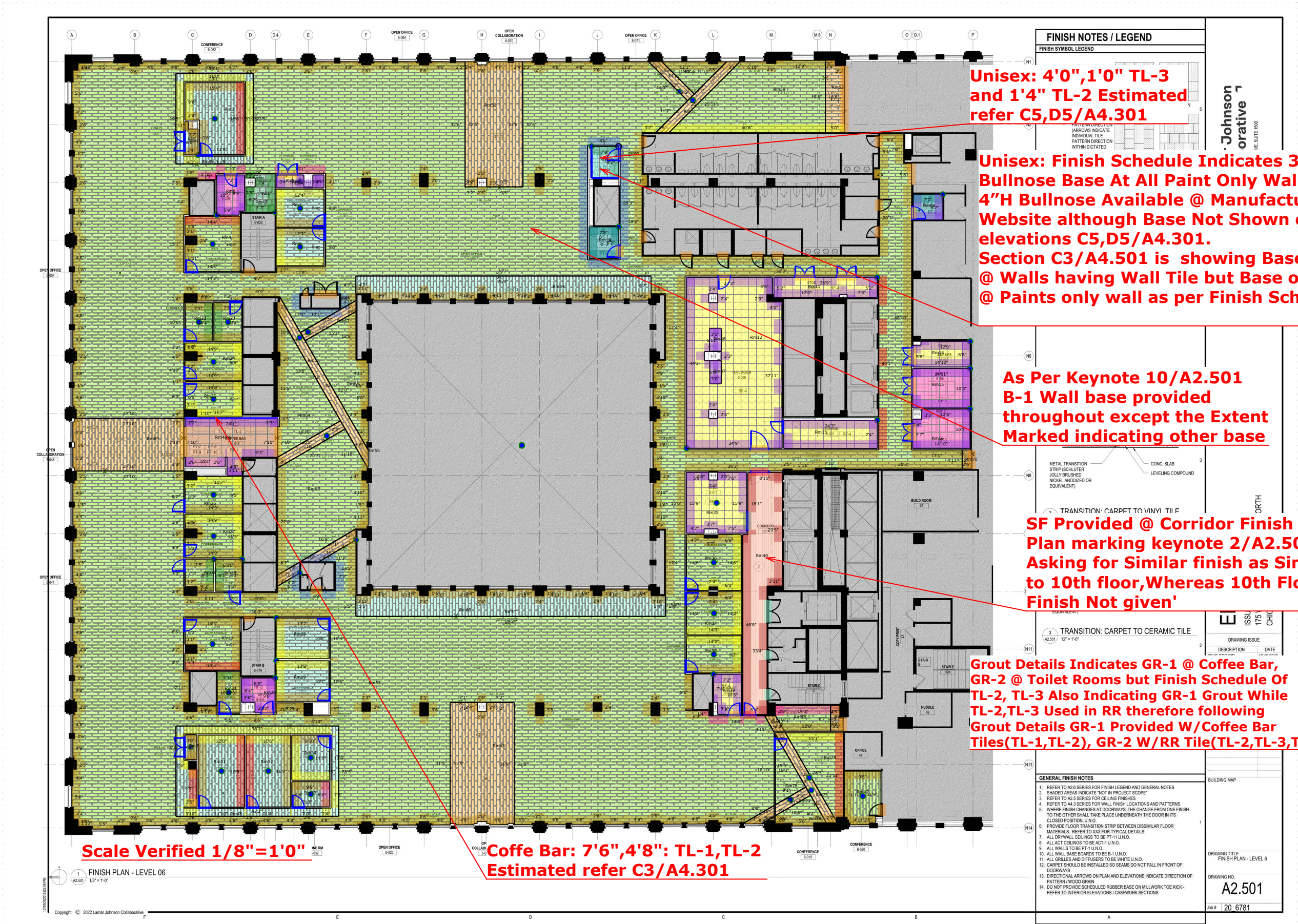

Finish Legends

	CPT-1 General Carpet: Interface, Net Effect B703, Caspian 103966, 9.84"x 39.37", Brick 9-27/32" x 39-3/8" SY
	CPT-2 Accent Carpet: Interface, Shiver Me Timbers, Magnolia, 9.84"x 39.37", Ashlar 9-27/32" x 39-3/8" SY
	CPT-3 Accent Carpet: Interface, Shiver Me Timbers, Spruce, 9.84"x 39.37", Ashlar 9-27/32" x 39-3/8" SY
	CPT-4 Accent Carpet: Flor, Twisted Spokes, Tidal, 19.685"x19.685", Ashlar 19-11/16" x 19-11/16" SY
	RF-1: Mohawk Group, Bolder C0010, Pebble 925, 36"x36", Monolithic 36" x 36" SF
	RF-2 : Mohawk Group, Reforestation, Cumberland 838, 9.25"x59", Monolithic 9-1/4" x 59" SF
	RF-3 : Tarkett, Iq Granit Sd, Dark Grey 0188, 24"X24", Monolithic 24" x 24" SF
	RF-4 : Tarkett, Iq Granit, Grey 0948, 24"X24", Monolithic 24" x 24" SF
	TL-1: Wall Tile Daltile, Color Match Special, Galaxy 1469, Glossy, 4"x12", Vertical Stack 4" x 12" SF
	TL-2 Wall Tile @ Cofee Bar: Daltile, Color Match Special, Electric Blue 1194, Glossy, 4"X12", Vertical Stack @ Coffee Bar 4" x 12" SF
	TL-2 Wall Tile @ Unisex: Daltile, Color Match Special, Electric Blue 1194, Glossy, 4"X12", Stack Bond @ Unisex 4" x 12" SF
	TL-3 Wall Tile: Daltile, Color Linear, Artic White, Glossy, 4" X 12", Vertical Stack 4" x 12" SF
	TL-4 Floor Tile: Virginia Tile, Crossville Inc Alaska, Glacier Field Tile, Matte Rectified, 24"x48", Vertical Stack 24" x 48" SF
	Corridor SF
	Floor Grout GR2: TL-4 SF
	Wall Grout GR1: TL-1,TL-2 @ Cofee bar SF
	Wall Grout GR2: TL-2,TL-3 SF
	Waterproofing Floor:TL-4 SF
	Waterproofing Wall: TL-2,TL-3 SF
	Base @ Corridor 0" LF
	B-1 Vinyl Rubber Base(Cove) : Tarkett, Custom To Match PT-1, 2 1/2" H, Rolled Coils @ PT-1 Location 0" LF
	B-1 Vinyl Rubber Base(Straight) : Tarkett, Custom To Match PT-1, 2 1/2" H, Rolled Coils @ PT-1 Location 0" LF
	B-2 Vinyl Rubber Base(Cove): Tarkett, Custom To Match PT-2, 2 1/2" H, Rolled Coils @ PT-2/WC-1 Location 0" LF
	B-2 Vinyl Rubber Base(Straight): Tarkett, Custom To Match PT-2, 2 1/2" H, Rolled Coils @ PT-2/WC-1 Location 0" LF
	B-3 Vinyl Rubber Base(Straight): Tarkett, Custom To Match PT-3, 2 1/2" H, Rolled Coils @ PT-3 Locations 0" LF
	B-4 Vinyl Rubber Base(Straight): Tarkett, Custom To Match PT-4, 2 1/2" H, Rolled Coils @ PT-4 Locations 0" LF
	B-5 Vinyl Rubber Base(Straight): Tarkett, Custom To Match PT-5, 2 1/2" H, Rolled Coils @ PT-5 Locations 0" LF
	B-6 Vinyl Rubber Base(Straight): Tarkett, Custom To Match PT-6, 2 1/2" H, Rolled Coils @ PT-6 Locations 0" LF
	B-7 Vinyl Rubber Base(Cove): Tarkett, Custom To Match PT-9, 2 1/2" H, Rolled Coils @ PT-7,8,9,10 Locations 0" LF
	TL-4 Bullnose Base: Virginia Tile, Crossville Inc Alaska, Glacier Field Tile, Matte Rectified, 4"H 0" LF
	Transition 2/A2.501 Carpet To Vinyl Tile: Metal Transition Strip (Schluter Jolly Brushed Nickel Anodized Or Equivalent) 0" LF
	Transition Carpet To Corridor 0" LF
	Transition Corridor To Existing 0" LF
	Transition Carpet To Existing 0" LF
	Transition Resilient To Existing 0" LF
	Transition Resilient To Corridor 0" LF
	Transition 3/A2.501 Carpet To Ceramic Tile: Metal Transition Strip (Schluter Jolly Brushed Nickel Anodized Or Equivalent) 0" LF
	Horizontal Trim C1/A4.51 Tile Outside Corner: Metal Edge Profile: Schluter Jolly, Finish As Scheduled 0" LF
	TL-4 Base IC EA

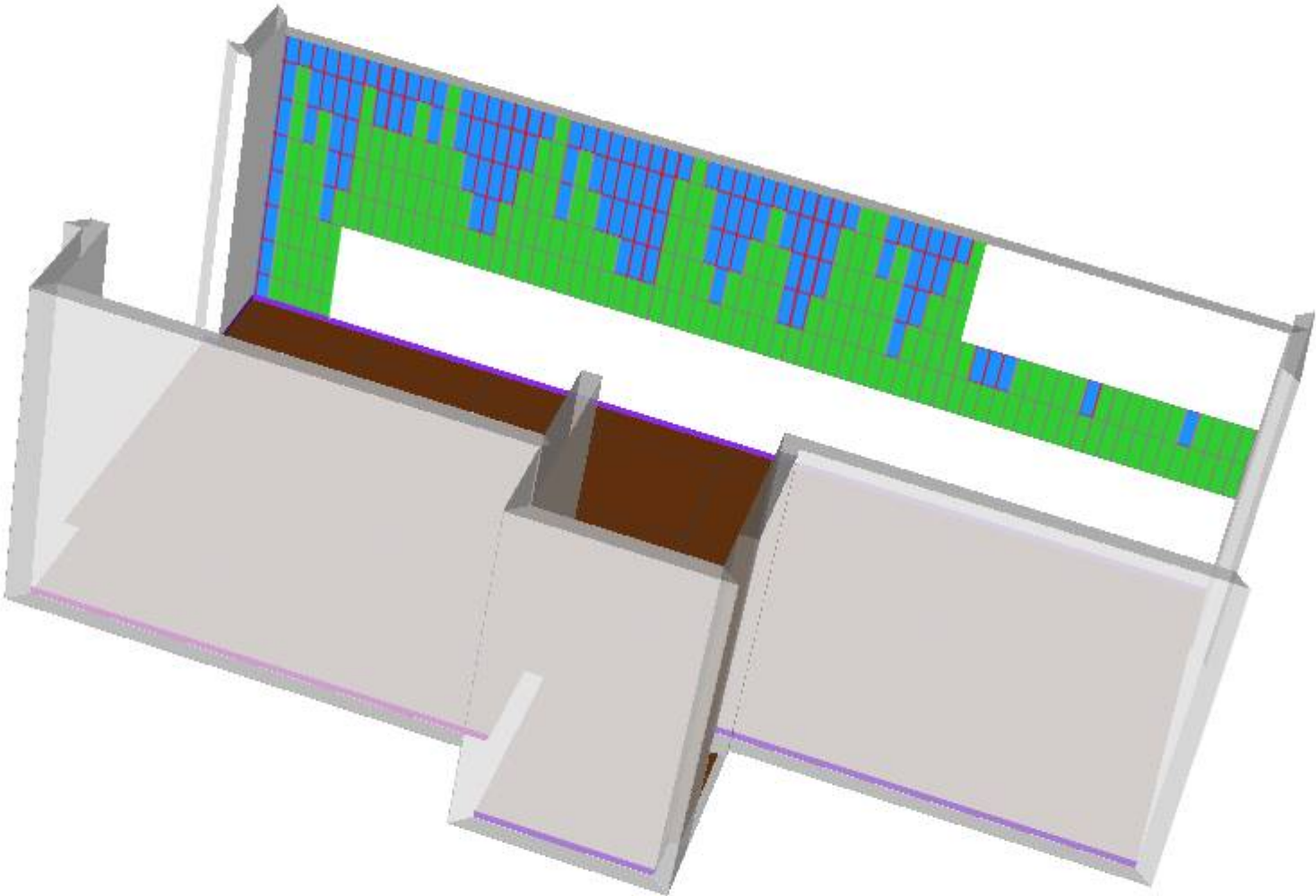

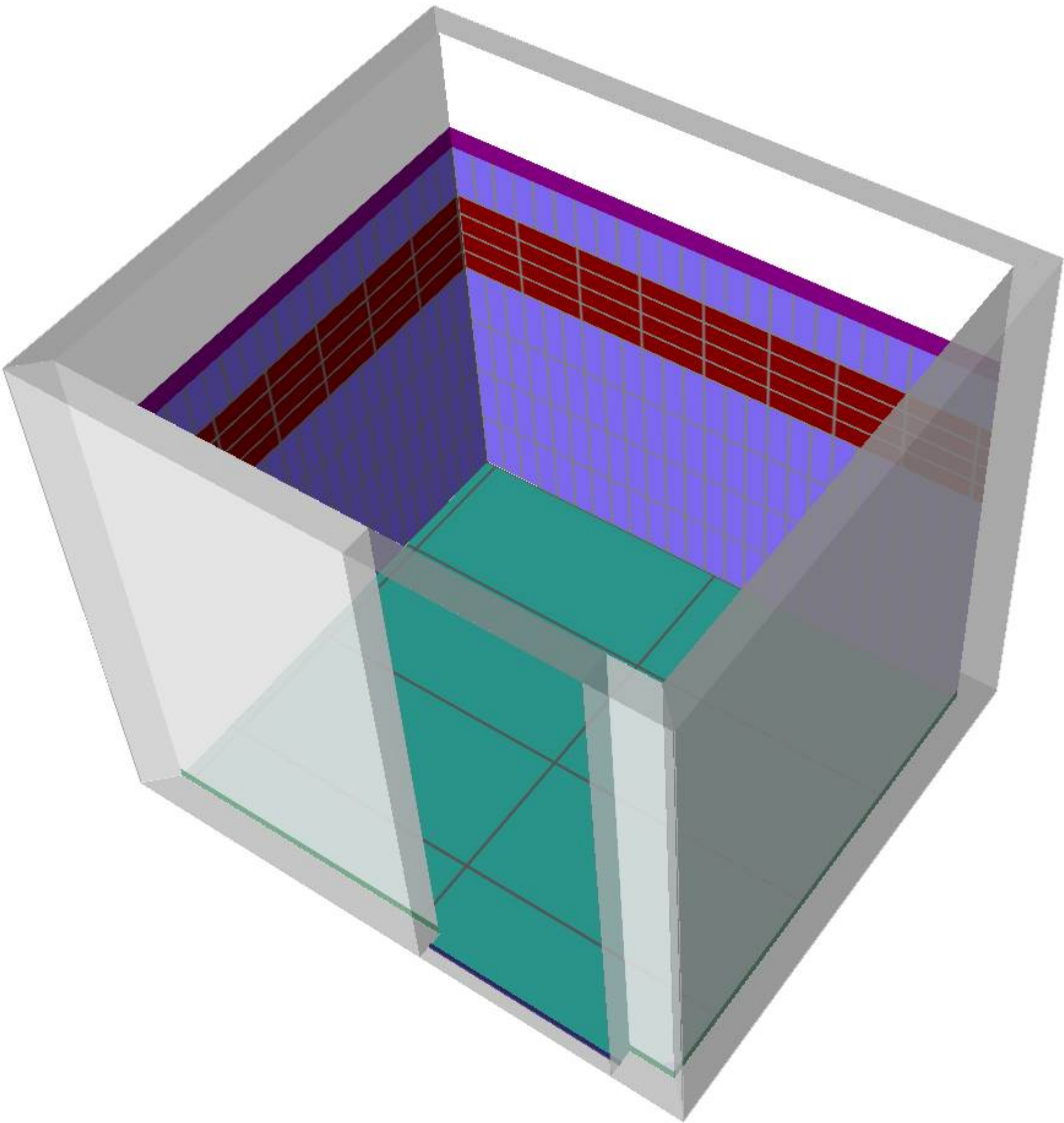

Project: Enova - 175 W Jackson St
Architect: Lamar Johnson Collaborative
Date on Drawings: 12.16.22



Due to the possibility of error, the final verification of quantities submitted by Pinnacle must be reviewed and is the responsibility of the sales person submitting the proposal to its respective client

Item Name	Unit	Qty	Net Area	Waste Add-on
CPT-1 General Carpet: Interface, Net Effect B703, Caspian 103966, 9.84"x 39.37", Brick	SY	2,540	2,419	5%
CPT-2 Accent Carpet: Interface, Shiver Me Timbers, Magnolia, 9.84"x 39.37", Ashlar	SY	230	219	5%
CPT-3 Accent Carpet: Interface, Shiver Me Timbers, Spruce, 9.84"x 39.37", Ashlar	SY	336	320	5%
CPT-4 Accent Carpet: Flor, Twisted Spokes, Tidal, 19.685"x19.685", Ashlar	SY	8	8	5%
RF-1: Mohawk Group, Bolder C0010, Pebble 925, 36"x36", Monolithic	SF	304	289	5%
RF-2 : Mohawk Group, Reforestation, Cumberland 838, 9.25"x59", Monolithic	SF	123	114	8%
RF-3 : Tarkett, Iq Granit Sd, Dark Grey 0188, 24"x24", Monolithic	SF	467	444	5%
RF-4 : Tarkett, Iq Granit, Grey 0948, 24"x24", Monolithic	SF	1,913	1,822	5%
TL-1: Wall Tile Daltile, Color Match Special, Galaxy 1469, Glossy, 4"x12", Vertical Stack	SF	64	63	2%
TL-2 Wall Tile @ Cofee Bar: Daltile, Color Match Special, Electric Blue 1194, Glossy, 4"x12", Vertical Stack	SF	41	37	12%
TL-2 Wall Tile @ Unisex: Daltile, Color Match Special, Electric Blue 1194, Glossy, 4"x12", Stack Bond	SF	21	20	3%
TL-3 Wall Tile: Daltile, Color Linear, Artic White, Glossy, 4" X 12", Vertical Stack	SF	76	76	
TL-4 Floor Tile: Virginia Tile, Crossville Inc Alaska, Glacier Field Tile, Matte Rectified, 24"x48", Vertical Stack	SF	80	58	38%
Corridor	SF	497	497	
Floor Grout GR2: TL-4	SF	58	58	
Wall Grout GR1: TL-1,TL-2 @ Cofee bar	SF	99	99	
Wall Grout GR2: TL-2,TL-3	SF	96	96	
Waterproofing Floor:TL-4	SF	58	58	
Waterproofing Wall: TL-2,TL-3	SF	96	96	
Base @ Corridor	LF	110	110	
B-1 Vinyl Rubber Base(Cove) : Tarkett, Custom To Match PT-1, 2 1/2" H, Rolled Coils @ PT-1 Location	LF	690	690	
B-1 Vinyl Rubber Base(Straight) : Tarkett, Custom To Match PT-1, 2 1/2" H, Rolled Coils @ PT-1 Location	LF	2,419	2,419	
B-2 Vinyl Rubber Base(Cove): Tarkett, Custom To Match PT-2, 2 1/2" H, Rolled Coils @ PT-2/WC-1	LF	36	36	
B-2 Vinyl Rubber Base(Straight): Tarkett, Custom To Match PT-2, 2 1/2" H, Rolled Coils @ PT-2/WC-1	LF	514	514	
B-3 Vinyl Rubber Base(Straight): Tarkett, Custom To Match PT-3, 2 1/2" H, Rolled Coils @ PT-3 Location	LF	123	123	
B-4 Vinyl Rubber Base(Straight): Tarkett, Custom To Match PT-4, 2 1/2" H, Rolled Coils @ PT-4 Location	LF	147	147	

B-5 Vinyl Rubber Base(Straight): Tarkett, Custom To Match PT-5, 2 1/2" H, Rolled Coils @ PT-5 Lo	LF	75	75	
B-6 Vinyl Rubber Base(Straight): Tarkett, Custom To Match PT-6, 2 1/2" H, Rolled Coils @ PT-6 Lo	LF	55	55	
B-7 Vinyl Rubber Base(Cove): Tarkett, Custom To Match PT-9, 2 1/2" H, Rolled Coils @ PT-7,8,9,1	LF	10	10	
TL-4 Bullnose Base: Virginia Tile, Crossville Inc Alaska, Glacier Field Tile, Matte Rectified, 4"H	LF	12	12	
Transition 2/A2.501 Carpet To Vinyl Tile: Metal Transition Strip (Schluter Jolly Brushed Nickel And	LF	67	67	
Transition Carpet To Corridor	LF	8	8	
Transition Corridor To Existing	LF	12	12	
Transition Carpet To Existing	LF	78	78	
Transition Resilient To Existing	LF	3	3	
Transition Resilient To Corridor	LF	5	5	
Transition 3/A2.501 Carpet To Ceramic Tile: Metal Transition Strip (Schluter Jolly Brushed Nickel	LF	3	3	
Horizontal Trim C1/A4.51 Tile Outside Corner: Metal Edge Profile: Schluter Jolly, Finish As Schedu	LF	15	15	
TL-4 Base IC	EA	1	1	

Date: November 3, 2023

QUALIFICATIONS

Project: Enova - 175 W Jackson St

Architect: Lamar Johnson Collaborative

Date on Drawings: 12.16.22

Address: 175 West Jackson Chicago IL

Area: 35257 SF

Estimator: P.E

Scale: 1/8"=1'0"

Disclaimer: Tile Pattern Estimated for Quantity Purpose Only. Please Don't Use It for Shop Drawing.

SPECIFICATIONS

Attached as a Separate PDF

Project Information as Per ITB

Additional Notes:

- Enova currently occupies the 5th, half of 6th, and 10th floors. This project will take over the other half of the 6th floor (additional 35,257 RSF of space)
- The existing half of the 6th floor (south side) will remain operational during construction of this project
- Building arch standards at the link
- Building Rules & Regulations are at the link. Please account for these in your proposals
- **The structure is clay tile, therefore trenching is required (not coring)**
- **Provide a breakout of the following for FURNISH ONLY**

Scope Of Project/A0.001

SCOPE OF PROJECT: DEMOLITION OF EXISTING WEST SUITE TO CREATE A COMBINED SINGLE TENANT SUITE. SCOPE INCLUDES [2] NEW SERVER ROOMS, [1] NEW UPS CABINET ROOM, [2] NEW IDF ROOMS. NEW OPEN WORK AREAS, CAFE, PRIVATE OFFICES AND CONFERENCE ROOMS.

DRAWING SET

A0.001 Cover & Index

A0.010 Abbreviations, Symbols, General Notes

A0.011 Typical Mounting Heights, Accessibility Requirements

A0.300 Project Schedules

A0.310-0.316 Project Specs

A1.101 Demolition Partition Plan - Level 6

A1.102 Demolition Reflected Ceiling Plan - Level 6

A2.101 Partition Plan - Level 6

A2.301 Reflected Ceiling Plan -Level 6

A2.501 Finish Plan - Level 6

A4.301 Detail Plans & Interior Elevations

A4.501 Interior Details

A5.101 Partition Types And Details

A5.201 Door & Frame Types, Schedules And Details

Attic Stock Carpet & Carpet Tile/Section 096800,096813

1.3 ATTIC STOCK

- A. PROVIDE MINIMUM OF THREE PERCENT OVERAGE OF CALCULATED YARDAGE FOR EACH TYPE OF CARPET (CALCULATED YARDAGE SHALL INCLUDE CARPET NEEDED FOR COMPLETE INSTALLATION PLUS WASTE AND USABLE SCRAPS).

General Notes/A1.101

GENERAL NOTES	
1.	DEMOLITION AND SALVAGE WORK AREA TO BE CLEANED DAILY, ALL DIRT, DUST, DEBRIS, AND NON REUSABLE ITEMS SHALL BE REMOVED FROM THE PROJECT SITE.
2.	DURING DEMOLITION, ITEMS INDICATED TO REMAIN IN PLACE SHOULD BE CAREFULLY PROTECTED FROM DAMAGE. EXISTING ITEMS OR SURFACES TO REMAIN THAT ARE DAMAGED DURING DEMOLITION SHALL BE REFINISHED, REPAIRED, OR REPLACED BY THE G.C. TO THE ARCHITECT'S SATISFACTION AT NO ADDITIONAL COST.
3.	ALL WORK SHALL BE DONE IN ACCORDANCE WITH THE REQUIREMENTS OF THE LOCAL JURISDICTION AND ANY OTHER APPLICABLE CODES.
4.	ALL CONTRACTORS SHALL VISIT AND CAREFULLY EXAMINE SITE OF PROPOSED WORK AND ACQUAINT THEMSELVES WITH THE CONDITIONS UNDER WHICH WORK WILL BE PERFORMED AND THE NATURE AND EXTENT OF WORK INVOLVED.
15.	THE GENERAL CONTRACTOR SHALL RAISE & PROTECT EXISTING WINDOW BLINDS DURING DEMOLITION. CLEAN & VERIFY IN GOOD WORKING CONDITION PRIOR TO END OF CONSTRUCTION. GC SHALL COORDINATE ANY EXTERIOR WINDOW WALL BLINDS REPLACEMENT w/ BUILDING ENGINEER'S PREFERRED VENDOR.
16.	WITHIN SCOPE OF WORK ALL EXISTING FLOORING MATERIALS ARE TO BE REMOVED, UNLESS OTHERWISE NOTED. PATCH & REPAIR FLOOR AS REQUIRED, READY TO RECEIVE NEW FINISHES
17.	EXTERIOR WINDOWS: ALL EXTERIOR WINDOWS TO BE REPAIRED TO "GOOD WORKING ORDER". WHERE REQUIRED, REPLACE HARDWARE, WEATHER STRIPPING. ENSURE ALL INTERIOR FINISHES ARE FREE OF ATTACHMENTS, DEBRIS AND SCREW HOLES.

3

Demolition Alternate Notes/A1.101

ADDITIONAL ALTERNATE PRICING
1. PROVIDE AN ADDITIONAL ALTERNATE OR ALLOWANCE TO LEVEL THE SLAB TO 1/4" OVER 10'-0" FEET, CUMMULATIVE

Finish Plan Keynotes/A2.501

KEYED NOTES

- 1 EXISTING ELEVATOR DOORS AND FRAMES TO BE PAINTED (SP-1).
- 2 PROVIDE BUILDING STANDARD FINISHES AS REQUIRED. GC TO COORDINATE W/ BUILDING FOR ATTIC STOCK. REFER TO SAME CORRIDOR ON 10TH FLOOR FOR EXAMPLE OF LEVEL OF FINISH REQUIREMENT FOR CORRIDOR.
- 3 THE GENERAL CONTRACTOR SHALL PROVIDE LEVEL 5 DRYWALL FINISH AT THIS LOCATION, FOR TENANT SIGNAGE OR GRAPHICS BY OTHERS
- 4 GC TO PAINT ALL WALLS IN ROOM PT-6

4

General Finish Notes/A2.501

GENERAL FINISH NOTES

1. REFER TO A2.6 SERIES FOR FINISH LEGEND AND GENERAL NOTES
2. SHADED AREAS INDICATE "NOT IN PROJECT SCOPE"
3. REFER TO A2.5 SERIES FOR CEILING FINISHES
4. REFER TO A4.3 SERIES FOR WALL FINISH LOCATIONS AND PATTERNS
5. WHERE FINISH CHANGES AT DOORWAYS, THE CHANGE FROM ONE FINISH TO THE OTHER SHALL TAKE PLACE UNDERNEATH THE DOOR IN ITS CLOSED POSITION, U.N.O.
6. PROVIDE FLOOR TRANSITION STRIP BETWEEN DISSIMILAR FLOOR MATERIALS. REFER TO XXX FOR TYPICAL DETAILS
7. ALL DRYWALL CEILINGS TO BE PT-11 U.N.O.
8. ALL ACT CEILINGS TO BE ACT-1 U.N.O.
9. ALL WALLS TO BE PT-1 U.N.O.
10. ALL WALL BASE BOARDS TO BE B-1 U.N.O.
11. ALL GRILLES AND DIFFUSERS TO BE WHITE U.N.O.
12. CARPET SHOULD BE INSTALLED SO SEAMS DO NOT FALL IN FRONT OF DOORWAYS
13. DIRECTIONAL ARROWS ON PLAN AND ELEVATIONS INDICATE DIRECTION OF PATTERN / WOOD GRAIN
14. DO NOT PROVIDE SCHEDULED RUBBER BASE ON MILLWORK TOE KICK - REFER TO INTERIOR ELEVATIONS / CASEWORK SECTIONS

1

MATERIAL VERIFICATION LINKS

Carpet

Detail as Per File Received "Architectural Standards_175WJ"

Carpet

Modular Tile
Installation: Glue-down

Price: Standard amount of \$20 / square yard
material only, quick-ship carpet. Any upgrades in
carpet tile are at Tenant's expense.

CPT-1 General Carpet

Link: <https://www.klassis.com/wp-content/uploads/2016/04/Net-Effects-Collection.pdf>

Detail: Interface, Net Effect B703, Caspian 103966, 9.84"x 39.37", Brick

Size: 9.84"x 39.37" (Manufacture Size Taken, Bidset Indicates 19.685"x19.685" Custom)

CPT-2 Accent Carpet

Link: https://shop.interface.com/US/en-US/carpet-tile/shiver-me-timbers/7396C.html?dwvar_7396C_backing=GlasBac%C2%AE&dwvar_7396C_color=MAGNOLIA&dwvar_7396C_size=25cm%20x%201m&quantity=1

Detail: Interface, Shiver Me Timbers, Magnolia, 9.84"x 39.37", Ashlar

Size: 9.84"x 39.37"

CPT-3 Accent Carpet

Link: https://shop.interface.com/US/en-US/carpet-tile/shiver-me-timbers/7396C.html?dwvar_7396C_backing=GlasBac%C2%AE&dwvar_7396C_color=SPRUCE&dwvar_7396C_size=25cm%20x%201m&quantity=1

Detail: Interface, Shiver Me Timbers, Spruce, 9.84"x 39.37", Ashlar

Size: 9.84"x 39.37"

CPT-4 Accent Carpet

Link: https://www.flor.com/area-rugs_carpet-tiles/graphics-and-patterns/twisted-spokes---tidal/21-1394-07.html

Detail: Flor, Twisted Spokes, Tidal, 19.685"x19.685", Ashlar

Size: 19.685"x19.685"

CPT-1 (Alternate 16):

Link:

Detail: 24"x24" (Allowance \$22/SY)

Size: 24"x24" (Standard Size Taken as Detail not given in bidset)

Resilient

Detail as Per File Received "Architectural Standards_175WJ"

LVT

Interface
Studio Set A007 (or equal)

RF-1

Link: https://mohawcdn.blob.core.windows.net/pdf-product-prod/2_8160_C0010_Bolder.pdf

Detail: Mohawk Group, Bolder C0010, Pebble 925, 36"x36", Monolithic

Size: 36"x36"

Location: Coffee Bar

RF-2

Link: <https://mohawkdirectory.blob.core.windows.net/collection/C0188.pdf>

Detail: Mohawk Group, Reforestation, Cumberland 838, 9.25"x59", Monolithic

Size: 9.25"x59"

Location: Wellness

RF-3

Link: https://professionals.tarkett.com/en_EU/collection-C000120-iq-granit/granit-dark-grey-0188

Detail: Tarkett, Iq Granit Sd, Dark Grey 0188, 24"X24", Monolithic

Size: 24"X24"

Location: Server Rooms

RF-4

Link: https://www.tarkettsee.com/en_RS/collection-C000122-iq-granit-sd/granit-grey-0948

Detail: Tarkett, Iq Granit, Grey 0948, 24"X24", Monolithic

Size: 24"X24"

Location: Mail Room

Tile

TL-1 Wall Tile

Link: https://digitalassets.daltile.com/content/dam/Daltile/website/resources/products/product-catalogs/DAL_ColorMatch_SPEC.pdf

Detail: Daltile, Color Match Special, Galaxy 1469, Glossy, 4"x12", Vertical Stack

Size: 4"x12"

Location: Coffee Bar

Grout GR1: Mapie or EQ, Color TBD

TL-2 Wall Tile

Link: https://digitalassets.daltile.com/content/dam/Daltile/website/resources/products/product-catalogs/DAL_ColorMatch_SPEC.pdf

Detail: Daltile, Color Match Special, Electric Blue 1194, Glossy, 4"X12", Vertical Stack @ Coffee Bar, Stack Bond @ Unisex

Size: 4"x12"

Location: Coffee Bar, Unisex RR

Grout GR1: Mapie or EQ, Color TBD

TL-3 Wall Tile

Link: https://digitalassets.daltile.com/content/dam/Daltile/website/resources/products/sales-sheets/color-wheel/DAL_ColorWheel_Linear_SS.pdf

Detail: Daltile, Color Linear, Artic White, Glossy, 4" X 12", Vertical Stack

Size: 4"x12"

Location: Unisex Restroom

Grout GR1: Mapie or EQ, Color TBD

TL-4 Floor Tile

Link: https://www.crossvilleinc.com/getmedia/961675f6-b15b-476e-aebd-26dfe675e326/LIT_ASK_19_web.pdf

Detail: Virginia Tile, Crossville Inc Alaska, Glacier Field Tile, Matte Rectified, 24"x48", Vertical Stack

Size: 24"x48" (Manufacture Size Taken, Bidset Indicates 12"x48")



Location: Unisex Floor Tile

Grout GR2: Mapie or EQ, Color TBD

Note: 3" Bullnose Base At All Paint Only Walls

Note: 4"H Bullnose Available @ Manufacture Website

Coordinating Trim			
Nominal (in)	Actual (mm)	Thickness (mm)	Finish
6 x 12 Cove Base	150 x 297	10	UPS
4 x 24 Single Bullnose	97 x 597	10.5	UPS

6 x 12 Cove Base
4 x 24 Bullnose

Note: Grout Details Indicates GR-1 @ Coffee Bar, GR-2 @ Toilet Rooms but Finish Schedule Of TL-2, TL-3(Using @ Restrooms) Also Indicating GR1 Grout

GROUT

GR-1 MFR: MAPEI OR EQ.
COLOR: TBD
(COFFEE BAR)

GR-2 MFR: MAPEI OR EQ.
COLOR: EQ
(TOILET ROOM)

Base

Detail as Per File Received "Architectural Standards_175WJ"

Vinyl Base

Johnsonite 4" High
Straight at carpet, cove at VCT/LVT locations

WALL FINISHES

B-1 Vinyl Rubber Base: Tarkett, Custom To Match PT-1, 2 1/2" H, Rolled Coils @ PT-1 Location
B-2 Vinyl Rubber Base: Tarkett, Custom To Match PT-2, 2 1/2" H, Rolled Coils @ PT-2/WC-1 Location
B-3 Vinyl Rubber Base: Tarkett, Custom To Match PT-3, 2 1/2" H, Rolled Coils @ PT-3 Locations
B-4 Vinyl Rubber Base: Tarkett, Custom To Match PT-4, 2 1/2" H, Rolled Coils @ PT-4 Locations
B-5 Vinyl Rubber Base: Tarkett, Custom To Match PT-5, 2 1/2" H, Rolled Coils @ PT-5 Locations
B-6 Vinyl Rubber Base: Tarkett, Custom To Match PT-6, 2 1/2" H, Rolled Coils @ PT-6 Locations
B-7 Vinyl Rubber Base: Tarkett, Custom To Match PT-9, 2 1/2" H, Rolled Coils @ PT-7,8,9,10 Locations

Base Divided into Straight and Cove, Straight @ Carpet and Cove @ Hard Surfaces

a. EXTERIOR WALLS: 1/2" MINIMUM THICKNESS, 1/2" MINIMUM SET BACK LENGTH, NO NOTCHES

b. OUTSIDE CORNERS: JOB FORMED

c. INSIDE CORNERS: JOB FORMED

TL-4 Bullnose Base: Virginia Tile, Crossville Inc Alaska, Glacier Field Tile, Matte Rectified, 4"H

Trim and Transitions

Transition 2/A2.501 Carpet To Vinyl Tile: Metal Transition Strip (Schluter Jolly Brushed Nickel Anodized Or Equivalent)

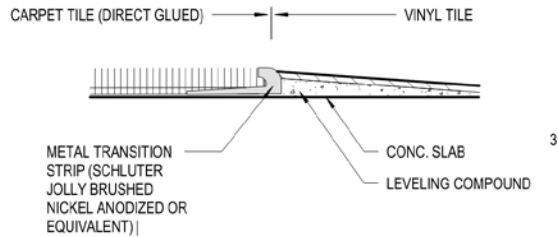

2
A2.501 12" = 1'-0"

TRANSITION: CARPET TO VINYL TILE

Transition 3/A2.501 Carpet To Ceramic Tile: Metal Transition Strip (Schluter Jolly Brushed Nickel Anodized Or Equivalent)

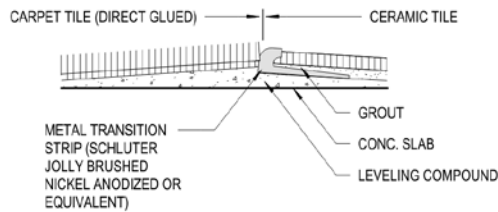

3
A2.501 12" = 1'-0"

TRANSITION: CARPET TO CERAMIC TILE

Trim C1/A4.51 Tile Outside Corner: Metal Edge Profile: Schluter Jolly, Finish As Scheduled

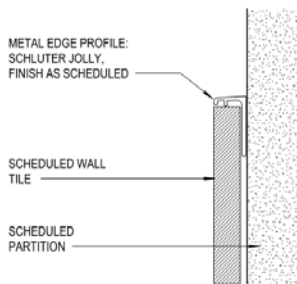

C1
A4.501 12" = 1'-0"

PLAN DETAIL- TILE OUTSIDE CORNER

TAKEOFF QUALIFICATIONS

- Unisex: 4'0", 1'0" TL-3 and 1'4" TL-2 Estimated refer C5,D5/A4.301
- Unisex: Finish Schedule Indicates 3" Bullnose Base At All Paint Only Walls but 4"H Bullnose Available @ Manufacture Website although Base Not Shown on elevations C5,D5/A4.301. Section C3/A4.501 is showing Base @ Walls having Wall Tile but Base only Provided @ Paints only wall as per Finish Schedule
- As Per Keynote 10/A2.501 B-1 Wall base provided throughout except the Extent Marked indicating other base
- SF Provided @ Corridor Finish Plan marking keynote 2/A2.501 Asking for Similar finish as Similar to 10th floor, Whereas 10th Floor Finish Not given

- Grout Details Indicates GR-1 @ Coffee Bar, GR-2 @ Toilet Rooms but Finish Schedule Of TL-2, TL-3 Also Indicating GR-1 Grout While TL-2, TL-3 Used in RR therefore following Grout Details GR-1 Provided W/Coffee Bar Tiles(TL-1, TL-2), GR-2 W/RR Tile(TL-2, TL-3, TL-4)
- Coffee Bar: 7'6", 4'8": TL-1, TL-2 Estimated refer C3/A4.301